

Step By Step

# Upload Your MidWestOne Card to Apple Pay

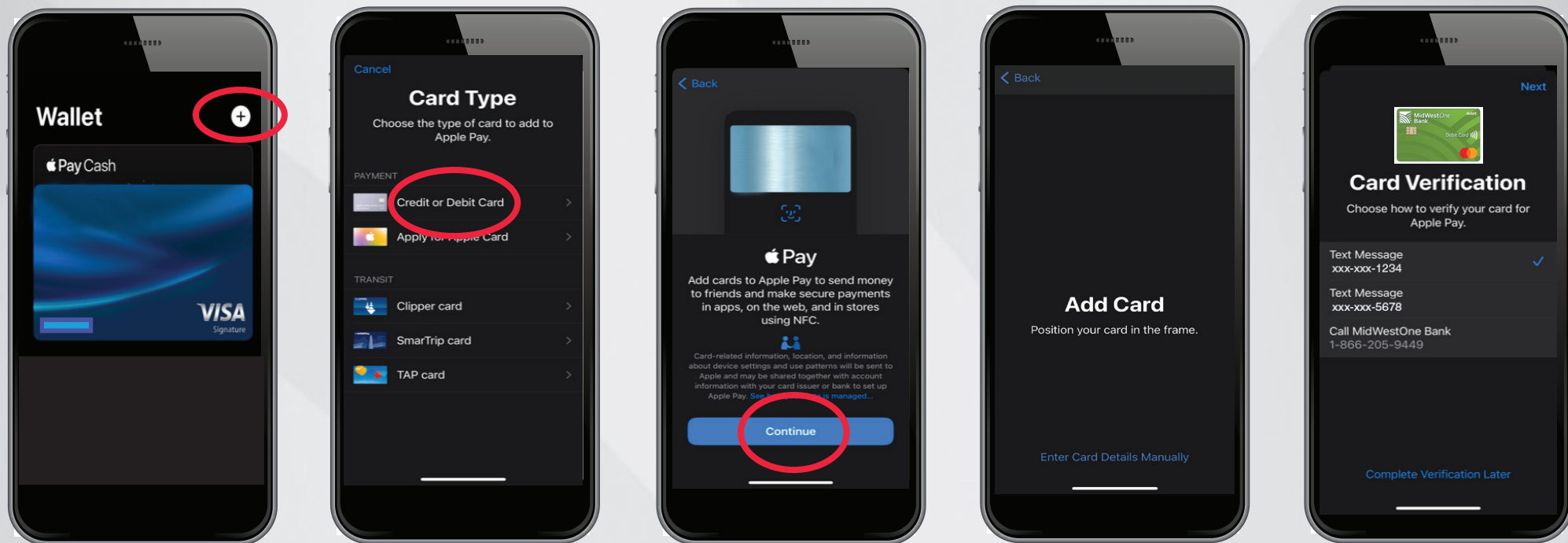

Your card design may be different than shown.

- Open the Wallet app on your iPhone
- Tap the + button in the top right corner
- Choose the type of card you want to add to Apple Pay, which is either “Credit or Debit Card” or “Apple Card.” This choice is only available if you don’t already have the Apple Card.
- Tap “Continue” on the Apple Pay set up screen
- Scan the **front or back of your card** with your iPhone’s camera or manually enter the card details (name and card number). Then tap “Next.”
- Enter the card’s expiration date and security code, then tap “Next.”

- Read and agree to the terms and conditions.
- Select a verification method, by email, text or call and enter the verification code when prompted. Then click “Next.”
- Your bank or card issuer will verify your information and once your card is verified, tap “Next” to start using Apple Pay.

If you want to set up Apple Pay on your iPad, Apple Watch or Mac, the process is nearly identical, but the first few steps may vary.



Member FDIC | [MidWestOne.bank](https://MidWestOne.bank) | 800.247.4418